

Q USL-Environmental-EU

- Cloud Gateways
- Switching
- WiFi
- Camera Security
- Door Access
- Integrations
- Advanced Hosting
- Accessories

Special Devices > [Environmental Sensor](#)

Datasheet

In The Box

Marketing Images

Installation Guide

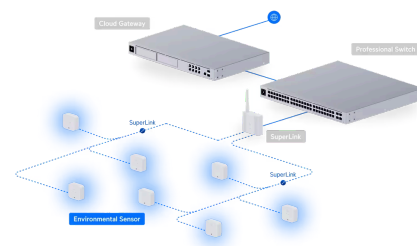
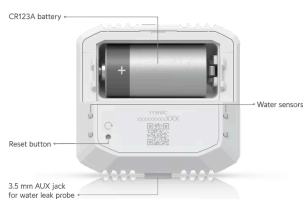
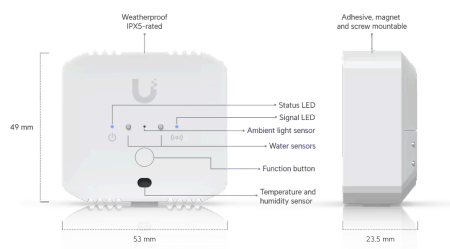

### ^ Mechanical

Dimensions  
 Device: 53 x 49 x 23.5 mm  
 (2.1 x 1.9 x 0.9")  
 Mount: 41.3 x 36.6 x 3.1 mm  
 (1.6 x 1.4 x 0.1")

Weight  
 Device: 47.8 g (1.7 oz)  
 With mount: 70 g (2.5 oz)

Enclosure Material  
 Polycarbonate

Mount Material  
 Galvanized steel

Mounting  
 Adhesive, magnet and screw mount

Weatherproofing  
 IPX5

### ^ Hardware

Connectivity  
 SuperLink (Proprietary)

#### Sensor Features

- Temperature Sensor ✓
- Humidity Sensor ✓
- Ambient Light Sensor ✓
- Water Sensor ✓
- Other  
 3.5 mm AUX jack for water leak probe

Power Method  
 Lithium battery CR123A

Battery Life  
 Up to 6 years

Supported Voltage Range  
 3V

Max. Power Consumption  
 34.9mW

#### Antenna Gain

SuperLink  
 0 dBi

#### Max. TX Power

SuperLink  
 14 dBm

#### Operating Frequency

US  
 915.6-927.6 MHz

EU	865.1-869.5MHz
Max. Range	
SuperLink	2 km (1.2 mi)
LEDs	(1) Status: R/B/W (1) Signal: B/R
Buttons	(1) Factory-reset (1) Function button
Ambient Operating Temperature	-20 to 40° C (-4 to 104° F)
Ambient Operating Humidity	10 to 90% noncondensing
NDAA Compliant	✓
Certifications	FCC, IC, CE

^ **Software**

Application Requirements

Web Application	UniFi Protect
Mobile App	UniFi Protect iOS™ and Android™

Stay in Touch

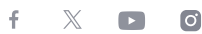
[Terms of Service](#) | [Privacy Policy](#) | [Legal](#) | [Cookies Settings](#)

© 2025 Ubiquiti, Inc. All rights reserved.